

# Croton Dam



# Croton Dam



# River Hydro Asset Key Terms

- Definitions/purpose of the major components and aspects critical of safe, compliant, and reliable operations:
- **Dam:** *the entire barrier to hold back the water (reservoir) typically consists of embankments, spillways, and powerhouse*
- **Spillway:** *Primary location for water flow when not used for generation*
- **Powerhouse:** *location of generation units*
- **Embankment:** *earthen barrier to hold back the reservoir, which contains a hydraulic barrier (core wall)*



# Croton Dam Structures

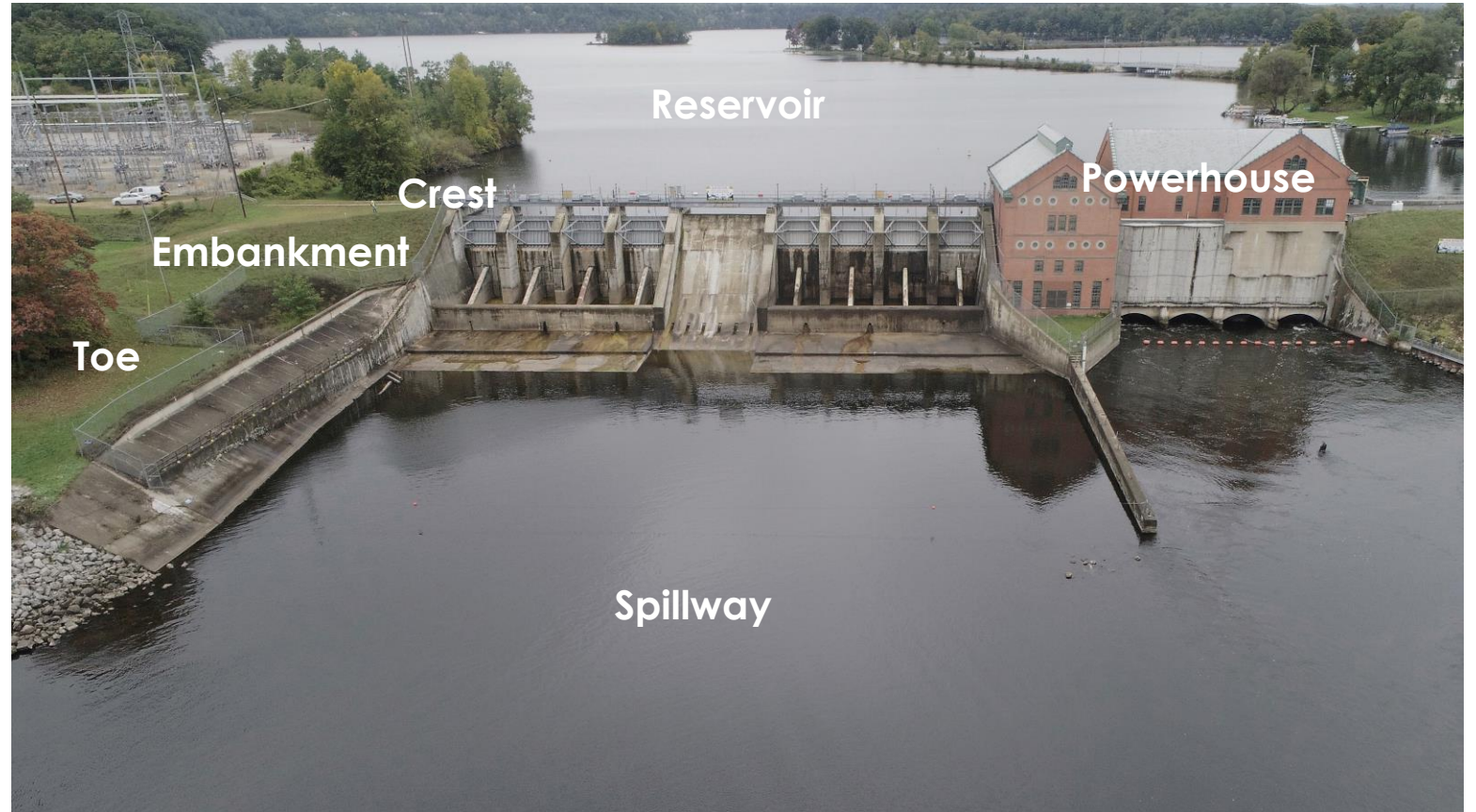

# Original Survey Drawings for Croton Dam

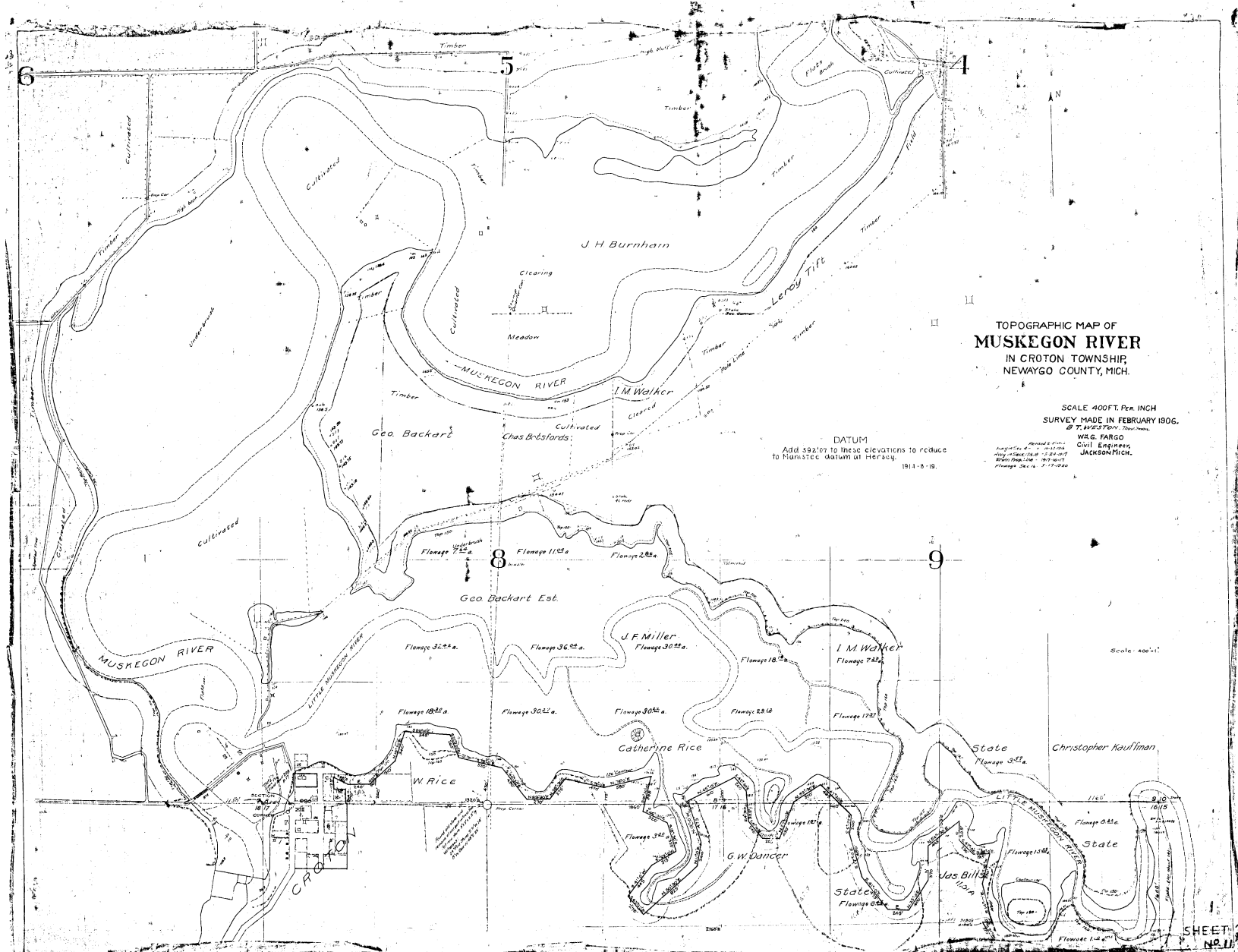

# Original Survey Drawings for Croton Dam

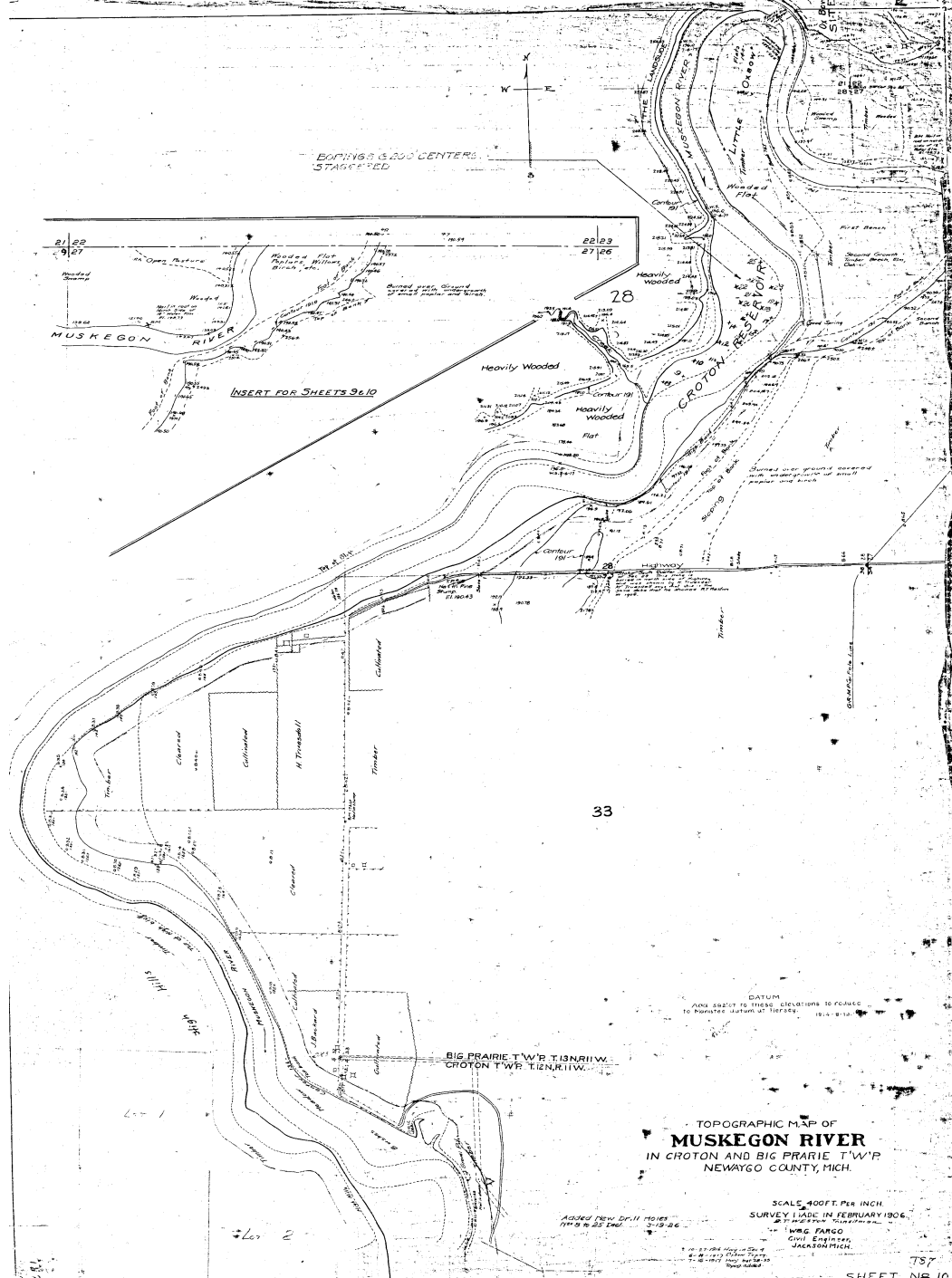

# Croton Hydro

- With a generating capacity of 8,850 kilowatts, two units began operation in 1907.
- Two more generating units were added in 1915.
- Croton was listed in the National Register of Historic Places in August 1979.
- Croton is one of three hydroelectric dams owned by Consumers Energy on the Muskegon River. It is downstream of the Rogers and Hardy dams.



# General Information

FERC License Expiration Date:

**June 30, 2034**

Dam Height (ft.): **45.5**

Length of Dam (ft.): **700**

Drainage Area (sq. miles): **2,290**

Impoundment Area (acres): **1,209**

Age (years): **115**

FERC Hazard Classification: **High\***

Approximate Population at Risk: **<800**

Approximate Recreation Use:

- 36,000 visitors annually
- About 300 docks
- 150 campsites
- 2 boat launches

\*Failure or misoperation will probably result in loss of human life.

